

VX-101 CRATE/GENERAL PURPOSE WASHER



TECHNICAL SPECIFICATIONS

Conveyor speed	0.5 - 0.8 mtr/min
Power supply	415V,3Ø+N 50Hz
Wash pump *3	0.9kW
Booster heater	12kW
Wash tank heater	9kW
Total power	25kW
Total current	35Amp
Wash tank capacity	80ltrs
Booster heater capacity	28.5 ltrs
Rinse water consumption (per hour)	200 ltrs
Min/max water pressure *1	200/600kPa
Min/max water temp *2	55/70°C
Max crate (LxW)	600 x 500 mm
Useful height	450 mm
Weight (empty)	210 kg
Weight (shipping)	247 kg
Dimension (shipping)	156Lx 90W x 180Hcm
Water connection	3/4" hose
Drain diameter	50 mm

STANDARD FEATURES

- Double skinned construction
- Deep formed tank
- Compact design
- Double tank filter with scrap screens & pump filter
- Removable stainless steel wash & rinse arms
- Electronic controls
- Rinse water saver



With a foot print of 1080mm x 715mm the VX-101 is a powerful compact conveyor washer. Built-in stainless steel (AISI 316) boiler. Wide inspection door with safety switch. This washer can be operated using cold or hot water.

TECHNICAL DRAWING

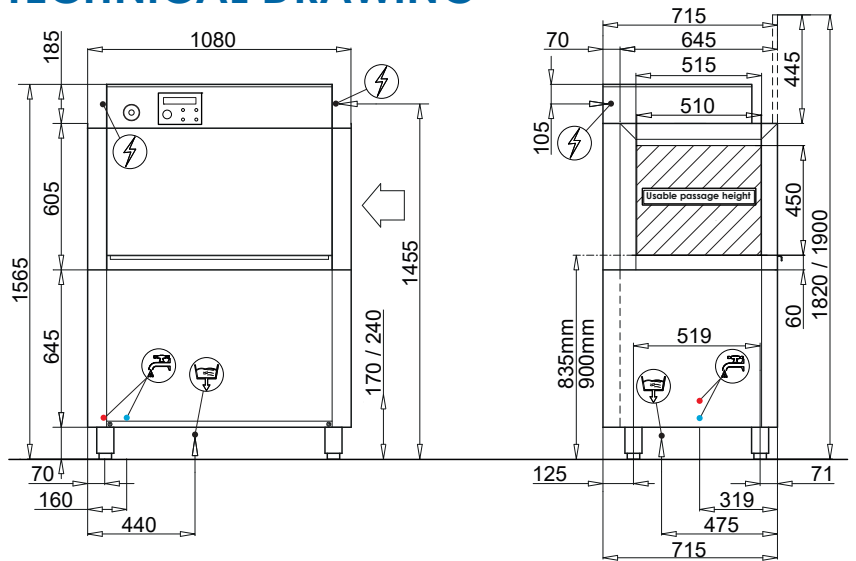

All details subject to change without notice

*1 Optional booster pump is available if the water pressure is below 200kPa; reducer required if over 600kPa

*2 Minimum incoming water temperature without loss of performance; units can operate with cold water at reduced performance.

Machine must be connected according to local regulations.

*3 Optional 2kW main pump.

Call Rhima Australia
today on **1300 347 944**

